



# LADY FREYA

22,76 m (74'8") | 4 Cabins | 8 Guests



Exterior

# LADY FREYA

22,76 m (74'8") | 4 Cabins | 8 Guests



Exterior

# LADY FREYA

22,76 m (74'8") | 4 Cabins | 8 Guests



Sailing

# LADY FREYA

22,76 m (74'8") | 4 Cabins | 8 Guests



Sailing

# LADY FREYA

22,76 m (74'8") | 4 Cabins | 8 Guests



Bird's Eye View

# LADY FREYA

22,76 m (74'8") | 4 Cabins | 8 Guests



Forward Seating Area

# LADY FREYA

22,76 m (74'8") | 4 Cabins | 8 Guests



Forward Suntanning Area

# LADY FREYA

22,76 m (74'8") | 4 Cabins | 8 Guests



Aft Dining & Lounging

# LADY FREYA

22,76 m (74'8") | 4 Cabins | 8 Guests



Aft Dining & Lounging

# LADY FREYA

22,76 m (74'8") | 4 Cabins | 8 Guests



Saloon

# LADY FREYA

22,76 m (74'8") | 4 Cabins | 8 Guests



Saloon

# LADY FREYA

22,76 m (74'8") | 4 Cabins | 8 Guests



Galley

# LADY FREYA

22,76 m (74'8") | 4 Cabins | 8 Guests



Aft Master Cabin

# LADY FREYA

22,76 m (74'8") | 4 Cabins | 8 Guests



Aft Master Cabin

# LADY FREYA

22,76 m (74'8") | 4 Cabins | 8 Guests



Forward Master Cabin

# LADY FREYA

22,76 m (74'8") | 4 Cabins | 8 Guests



Forward Master Cabin

# LADY FREYA

22,76 m (74'8") | 4 Cabins | 8 Guests



Port Side Double Cabin

# LADY FREYA

22,76 m (74'8") | 4 Cabins | 8 Guests



Starboard Side Double Cabin

# LADY FREYA

22,76 m (74'8") | 4 Cabins | 8 Guests



Aft Master Cabin Bathroom

# LADY FREYA

22,76 m (74'8") | 4 Cabins | 8 Guests



Forward Master Cabin Bathroom

# LADY FREYA

22,76 m (74'8") | 4 Cabins | 8 Guests



Double Cabin Bathrooms

# LADY FREYA

22,76 m (74'8") | 4 Cabins | 8 Guests



Double Cabin Bathrooms

# LADY FREYA

22,76 m (74'8") | 4 Cabins | 8 Guests



Sailing

# LADY FREYA

22,76 m (74'8") | 4 Cabins | 8 Guests

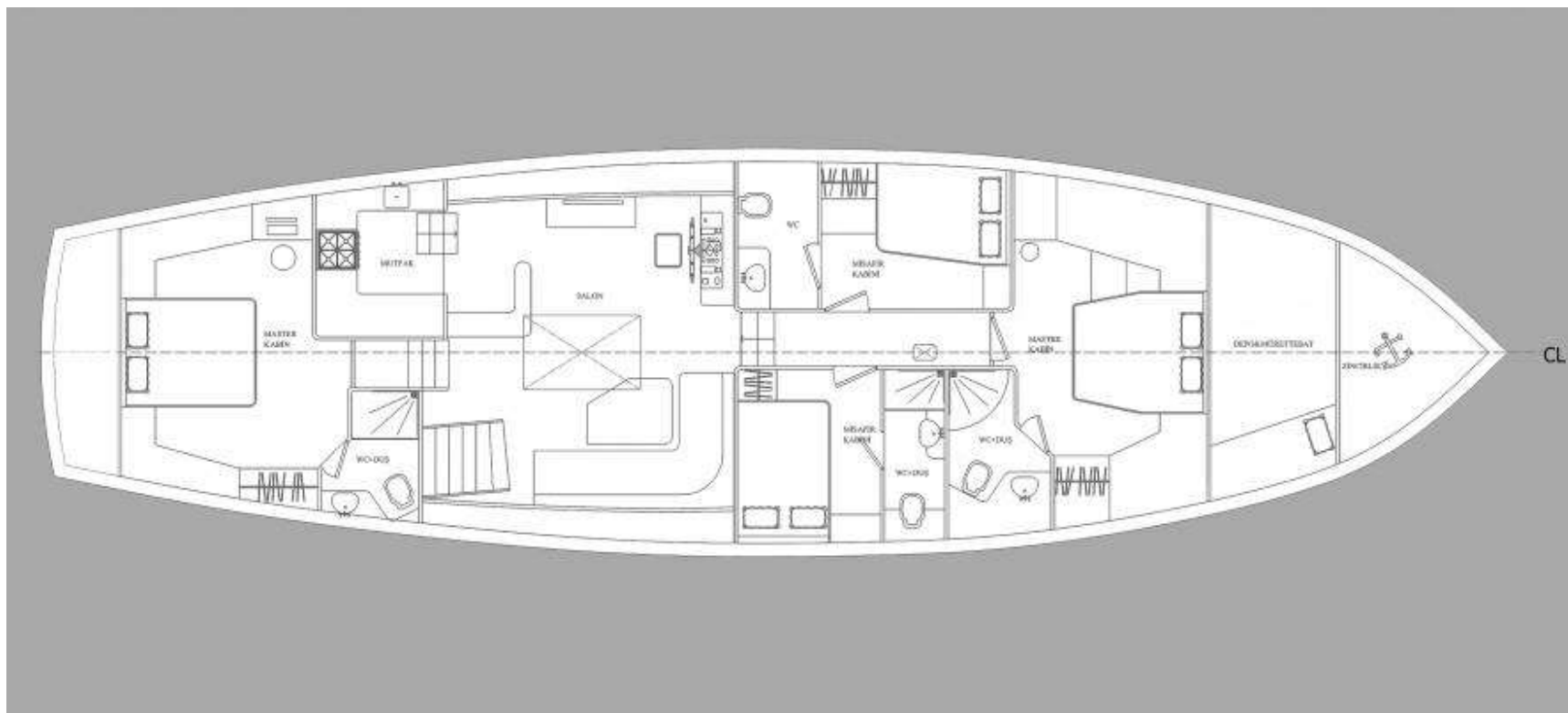

General Arrangement

# LADY FREYA

22,76 m (74'8") | 4 Cabins | 8 Guests

## SPECIFICATIONS

LOA (incl. pulpit)	25,50 m / 83'8"
Length Hull	22,76 m / 74'8"
Beam	6,05 m / 19'10"
Draught	2,74 m / 9'
Flag	Polish
Cabins	4
Guests	8
Built / Refit	2008 / 2025
Builder	Orion Shipyards
Displacement	48 tons
Engine(s)	1x Volvo Penta 425 hp
Generator(s)	1 x Onan 17,5 kW 1 x Albo Marine 14 kW
Fuel Consumption	40 liters/hr @ cruising speed
Cruising / Max. Speed	9 / 11 knots
Range	600 nm
Fuel Capacity	2800 l
Fresh Water Capacity	4000 l
A/C	24 Hours
Crew	Captain + 2

## ACCOMMODATION

- Saloon with A/C, open galley, dining area for 8 guests
- 1 aft master cabin with queen size bed, bathroom, A/C
- 1 forward master cabin with queen size bed, bathroom, A/C
- 2 port and starboard double cabins, bathroom, A/C
- 1 forward crew quarter for 3 crew members

## AMENITIES

- 1x 4,20m Tender 70 hp (8 guests)
- 1x Single Canoe
- 1x Double Canoe
- 2x Paddle Boards
- 1x Adult Water Ski
- 1x Child Water Ski
- 1x Mono Ski
- 1x Wakeboard
- 2x Ringos
- Snorkeling Equipment
- Fishing Equipment (2x rods, 2x longlines, 6x basic lines)
- Satellite TV in Saloon and Aft Deck
- DVD/CD Player in Saloon
- Board Games
- Bluetooth Speakers
- Wi-Fi